

88688A23 DUAL HANDLE TRIM CONTROL INSTALLATION, OPERATION AND MAINTENANCE INSTRUCTIONS

NOTICE to INSTALLER

After Completing Installation, These Instructions Should Be Placed with the Product For the Owner's Future Use.

⚠ CAUTION

Do not use external tie bar with this dual handle trim control or damage to drive units may result if improperly trimmed.

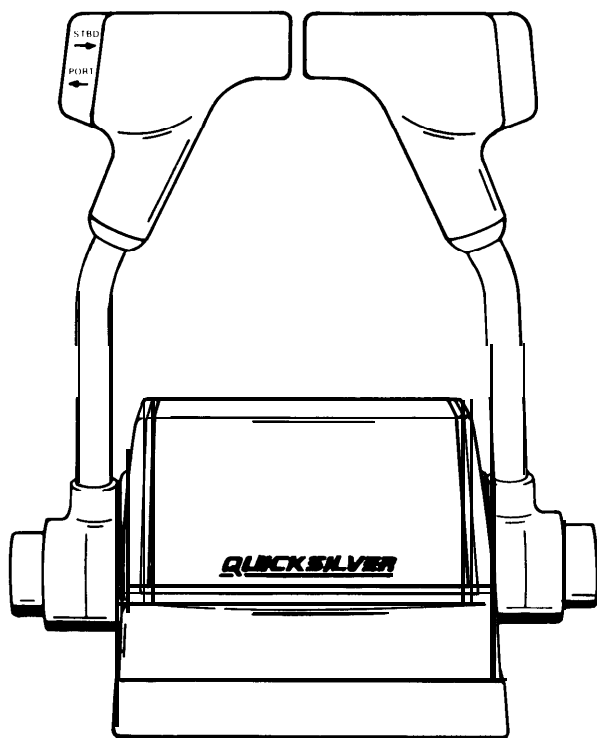

50030

Index

	Page
Notice to Installer/Owner	2
Maintenance and Replacement Parts	2
Selecting Remote Control Cables	2
Introduction	3
Installation	3
Starboard Side Control Module Cable Installation	
All MerCruiser Models (Except MIE) and Out-	
board Models (250 HP 3 Litre and Below)	4
Shift Cable	4
Throttle Cable	4
Port Side Control Module Cable Installation	
All MerCruiser Models (Except MIE) and Out-	
board Models (250 HP 3 Litre and Below)	5
Shift Cable	5
Throttle Cable	5
Starboard Side Control Module Cable Installation	
Outboard Models 250 HP 3.4 Litre and Above ...	6
Shift Cable	6
Throttle Cable	6
Port Side Control Module Cable Installation	
Outboard Models 250 HP 3.4 Litre and Above ...	7
Shift Cable	7
Throttle Cable	7
Remote Control Mounting	8
Locating and Drilling Mounting Area	8
Mounting Control	8
Trailer Switch Installation	10
Neutral Safety Switch and Power Trim	
Connections	10
Repositioning Control Handles	11
Operation	13

Notice

Throughout this publication, and on your motor, DANGER, WARNINGS and CAUTIONS (accompanied by the international HAZARD Symbol ) may be used to alert the installer/ user to special instructions concerning a particular service or operation that may be hazardous if performed incorrectly or carelessly. OBSERVE THEM CAREFULLY!

These "Safety Alerts" alone cannot eliminate the hazards that they signal. Strict compliance to these special instructions when performing the service, plus "common sense" operation, are major accident prevention measures.

DANGER

DANGER - Immediate hazards which WILL result in severe personal injury or death.

WARNING

WARNING - Hazards or unsafe practices which COULD result in severe personal injury or death.

CAUTION

CAUTION - Hazards or unsafe practices which could result minor personal injury or product or property damage.

IMPORTANT: - Indicates information or instructions that are necessary for proper operation and/or maintenance.

Maintenance and Replacement Parts

Maintenance and safety instructions are owner's responsibility and must be performed at intervals specified, following:

Normal Service - Every 50 hrs. of operation or 60 days (whichever comes first)

***Severe Service** - Every 25 hrs. of operation or 30 days (whichever comes first)

*Operation in a salt water area is considered "Severe Service."

1. Check fasteners, which secure remote control to boat, to be sure that they are tight.
2. Check set screws, which secure control handles to remote control, to ensure they are torqued to 60 lb. in. (7 N.m.)

3. Check electrical connections to be sure that they are tight, and that harness is properly secured and kept away from bilge water.
4. Inspection and lubrication of remote control assembly should be performed once each year (by your authorized dealer), or whenever remote control is disassembled, or if control operating effort has increased. Lubricate with Quicksilver 2-4-C Marine Lubricant or equivalent.
5. Quicksilver throttle and shift control cables recommended for use in this remote control.

Selecting Remote Control Cables

Refer to outboard "Quicksilver Dealers' Guide" to determine correct length of control cables.

IMPORTANT: Remote control cables **MUST BE THE CORRECT LENGTH**, sharp bends on too-short cables result in "kinks"; too-long cables require unnecessary bends and/or loops. Both conditions place extra stress on the cables.

IMPORTANT: Check throttle and shift cables **BEFORE** installing in control modules to ensure that set screws in cable end guides are tight. Torque cable end guide set screws to 20 to 25 lbs. in. (2.3 to 2.8 N.m.)

Shift Cable/Throttle Cable Lubrication Points Use Quicksilver 2-4-C Marine Lubricant.

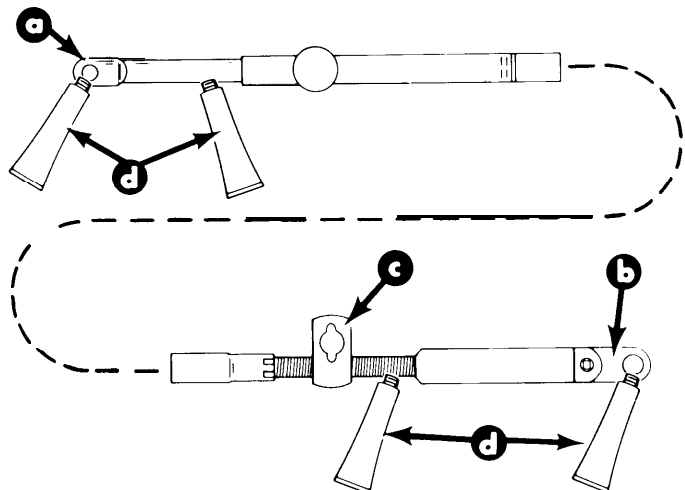

22005

- a - Remote Control End
- b - Engine End
- c - Adjusting Barrel
- d - Lubricant

Introduction

This console mount control provides complete one hand operation of the shift and throttle control. The control is equipped with a neutral start switch which must be connected to prevent accidental in-gear starting. The shift and throttle cables are not supplied with control; order cables separately after position of control is determined.

Quicksilver throttle and shift control cables are recommended for use in this remote control.

These installation instructions provide complete information for installing the remote control. Please read them carefully and thoroughly before starting installation.

Installation

1. Determine position of remote control, refer to mounting remote control.

⚠WARNING

If control handles are removed and reinstalled for any reason. The set screw in handle must be retorqued to 60 lbs. in. (7 N.m.) Failure to tighten screw securely could allow control handle to disengage with subsequent loss of throttle and shift control.

2. Install control cables to remote control. Refer to correct cable installation procedure in this manual. Note that cable installation is different, depending on which side the control will be installed. On some boat installations, it may be helpful to first make the cutout for remote control (using the attached template) and routing the control cables thru the boat before installing cables to control.
3. Mount the remote control following instructions. Make remote control wiring connections following "Wiring Diagram."
4. Install and adjust shift and throttle cables to power package following instructions which accompany the power package or refer to the Product Service Manual.

5. Final Checks and Adjustments.

- a. Re-check tightness of control handle set screw. Set screw should be torqued to 60 lb in. (7 N.m.)
- b. Before remote control is securely fastened, make sure parts are in place. Check to see that control cables are routed correctly.

⚠CAUTION

Do not try to shift remote control into "Reverse" on outboard installations when outboard is not running. Forcing the shift mechanism into reverse may damage the mechanism.

- c. Operate control handle several times (see "Caution" preceding.) Adjust control handle friction adjustment screw to desired tension. Any binding or stiffness in the operation of the control handle is usually caused by the following.
 - 1 - Bend or tension on control cables, close to the control.
 - 2 - Excessive number of bends in cables.
 - 3 - Bends are too small in cables.
 - 4 - Tight engine linkage.
- d. Adjust the control handle detent adjustment screw to desired tension.
- e. Check operation of neutral start switch. Engine must only be able to start when control handle is in neutral position. Make sure water intake in lower unit is in water when starting engine.

IMPORTANT: To prevent a load or bind on control cables (that will result in hard shifting and binding throttle action), secure cables straight-away and at least 3 ft. (91.4cm) from control modules. Be sure that control cables run parallel to each other and do not criss-cross.

Fasten control cables to boat with clamps, "D" washers and screws. Allow cables to protrude straight-away from control modules, parallel to each other, and do not fasten to boat for at least 3 ft. from control. This will prevent placing a load or bind on cables.

Starboard Side Control Module Cable Installation All MerCruiser Models (Except MIE) and Outboard Models (250 HP 3 Litre and Below)

IMPORTANT: Control modules are stamped port and starboard and control cables must be installed accordingly.

⚠ CAUTION

Before tightening cable fastener locknut, be sure that pin on end of cable fastener is completely thru cable end and shift/throttle lever. A pin, that is partially thru cable and lever, may cause fastener to bend when locknut is tightened.

Shift Cable

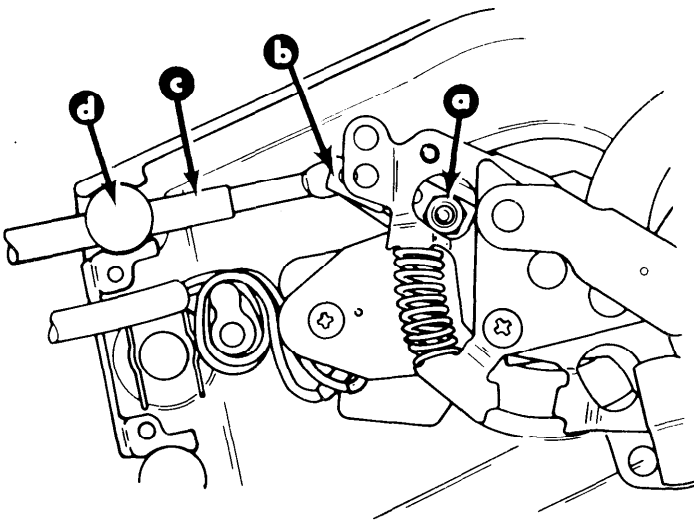

- a - Cable Fastener Locknut
- b - Cable Fastener
- c - Shift Cable
- d - Cable Anchor Barrel

Torque shift cable fastener locknut to 20 to 25 lbs. in. (2.3 to 2.8 N.m.)

Throttle Cable

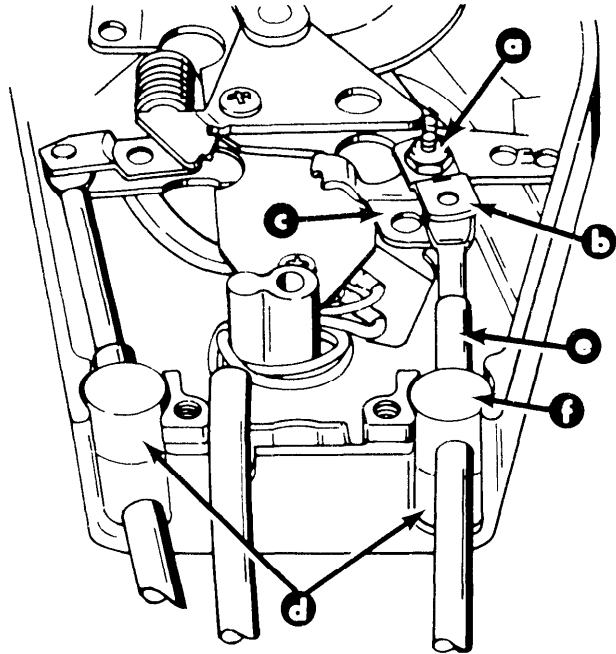

50030

- a - Cable Fastener Locknut
- b - Cable Fastener
- c Throttle Lever
- d - Spacers (From Parts Bag)
- e - Throttle Cable
- f Cable Anchor Barrel

Torque throttle cable fastener locknut to 20 to 25 lbs. in. (2.3 to 2.8 N.m.)

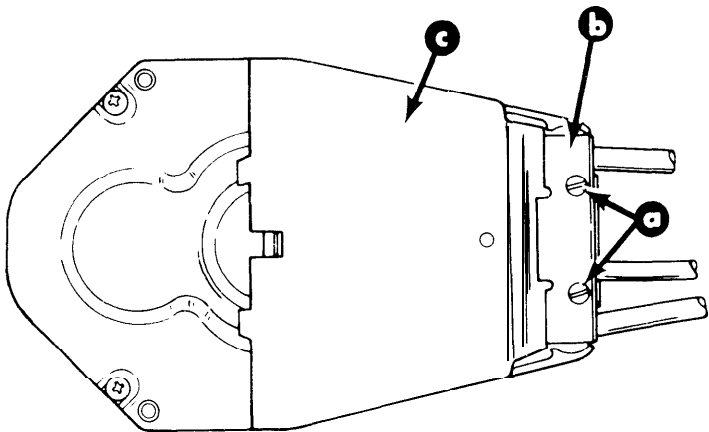

50030

- a - Screws
- b - Cable Retainer
- c - Access Cover

Position access cover and cable retainer onto back side of control and secure both using 2 screws. Torque screws to 60 lbs. in. (7 Nm)

Port Side Control Module Cable Installation All MerCruiser Models (Except MIE) and Outboard Models (250 HP 3 Litre and Below)

⚠ CAUTION

Before tightening cable fastener locknut, be sure that pin on end of cable fastener is completely thru cable end and shift/throttle lever. A pin, that is partially thru cable and lever, may cause fastener to bend when locknut is tightened.

Shift Cable

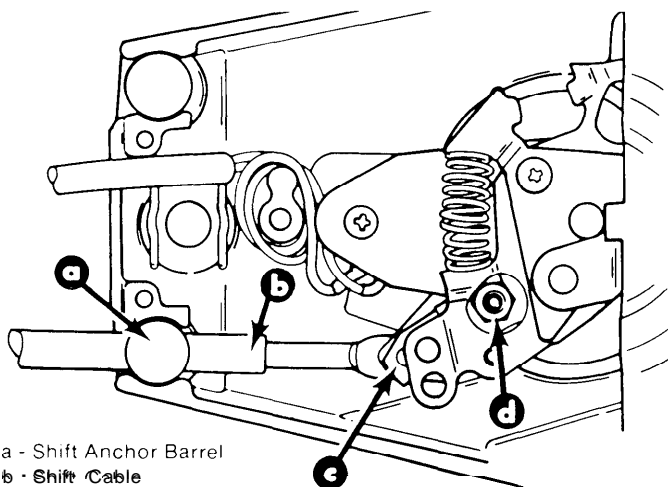

- a - Shift Anchor Barrel
- b - Shift Cable
- c - Cable Fastener
- d - Cable Fastener Locknut

50031

Torque shift cable fastener locknut to 20-25 lbs. in. (2.3 to 2.8 N.m.)

Throttle Cable

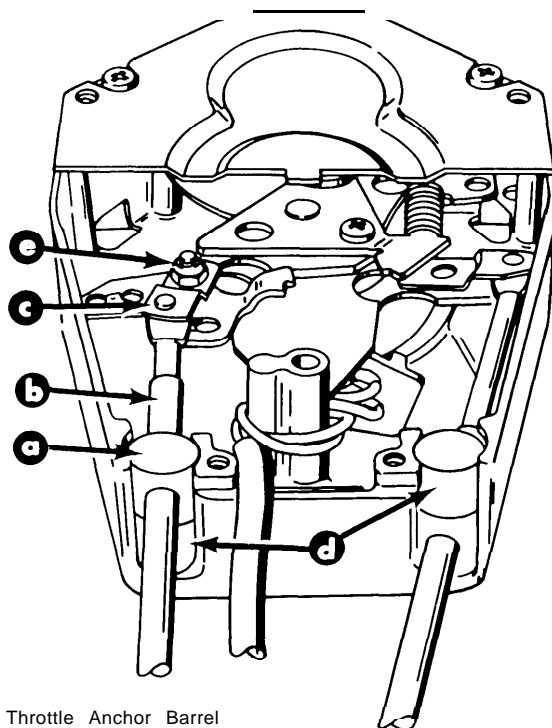

50030

- a - Throttle Anchor Barrel
- b - Throttle Cable
- c - Cable Fastener
- d - Spacers (From Parts Bag)
- e - Cable Fastener Locknut

Torque throttle cable fastener locknut to 20 to 25 lbs in. (2.3 to 2.8 N.m.)

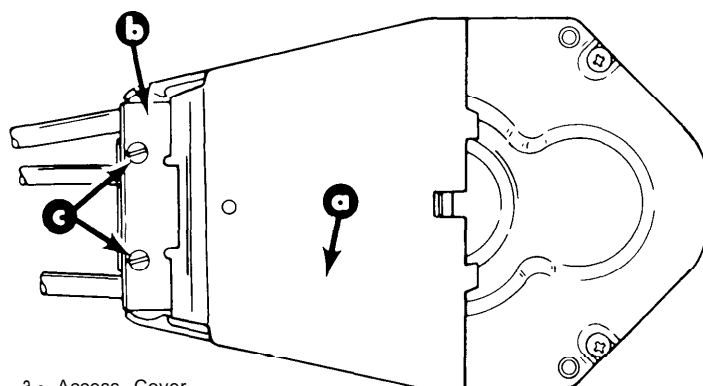

- a - Access Cover
- b - Cable Retainer
- c - Screws

50030

Position access cover and cable retainer onto back side of control and secure both to control with 2 screws. Torque access cover and cable retainer screws to 60 lbs. in. (7 N.m.)

Starboard Side Control Module Cable Installation (Outboard Models 250 HP 3.4 Litre and Above)

⚠CAUTION

Before tightening cable fastener locknut, be sure that pin (on end of cable fastener) is completely thru cable end and shift/throttle lever. A pin, that is partially thru cable and lever, may cause fastener to bend when locknut is tightened.

Shift Cable

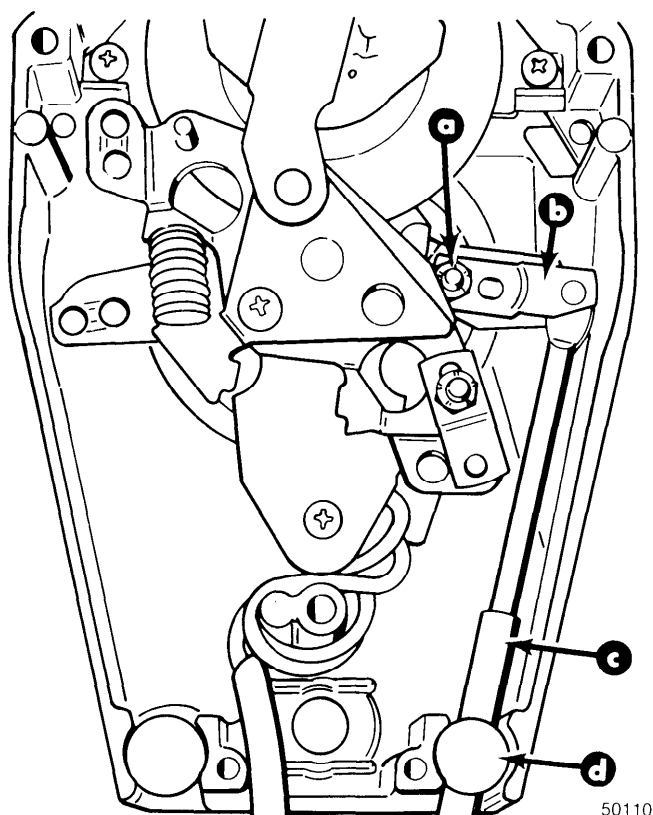

- a - Cable Fastener Locknut
- b - Cable Fastener
- c - Shift Cable
- d - Cable Anchor Barrel

IMPORTANT: Cable fastener (b) must be relocated to position as shown.

Torque shift cable fastener locknut to **20-25** lbs. in. (2.3 to 2.8 N.m.)

Throttle Cable

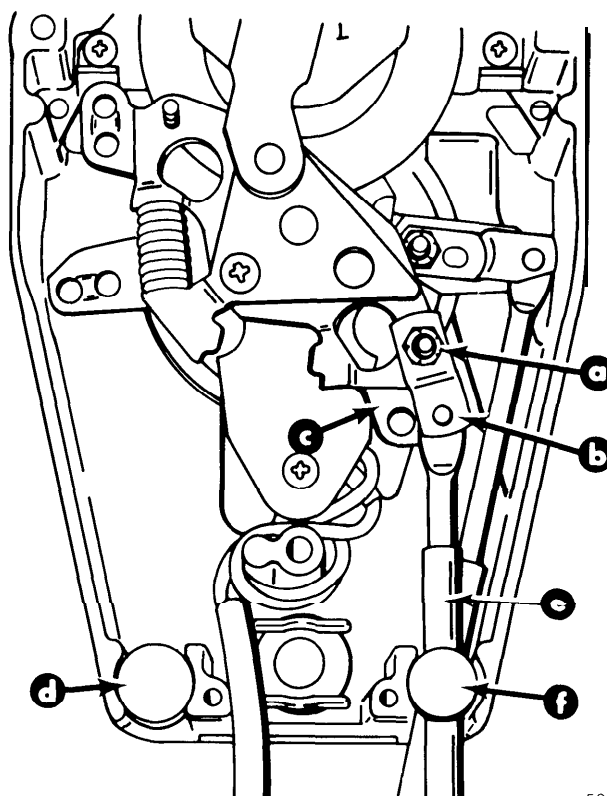

- a - Cable Fastener Locknut
- b - Cable Fastener
- c - Throttle Lever
- d - Spacer (From Parts Bay)
- e - Throttle Cable
- f - Cable Anchor Barrel

Torque throttle cable fastener locknut to 20 to 25 lbs in. (2.3 to 2.8 N m)

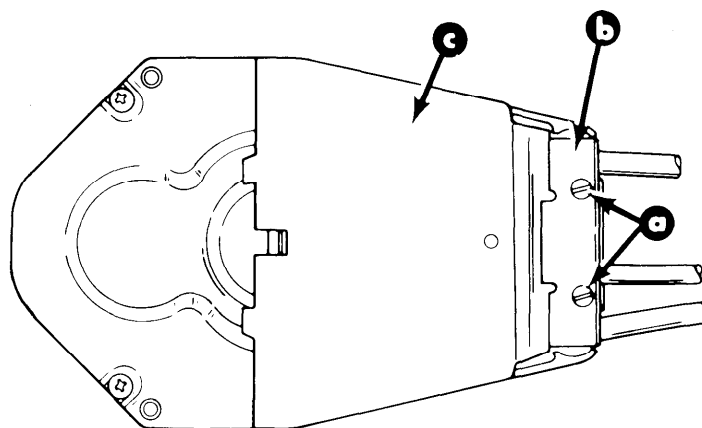

- a - Screws
- b - Cable Retainer
- c - Access Cover

Position access cover and cable retainer onto back side of control and secure both to control with 2 screws. **Torque access cover and cable retainer screws to 60 lbs. in. (7 N.m.)**

Port Side Control Module Cable Installation (Outboard Models 250 HP 3.4 Litre and Above)

The control cables in the starboard side module are installed differently than those in the port side module, therefore, the back cover of each control has been stamped "PORT" or "STBD."

⚠ CAUTION

Before tightening cable fastener locknut, be sure that pin (on end of cable fastener) is completely thru cable end and shift/throttle lever. A pin, which is partially thru cable and lever, may cause fastener to bend when locknut is tightened.

Shift Cable

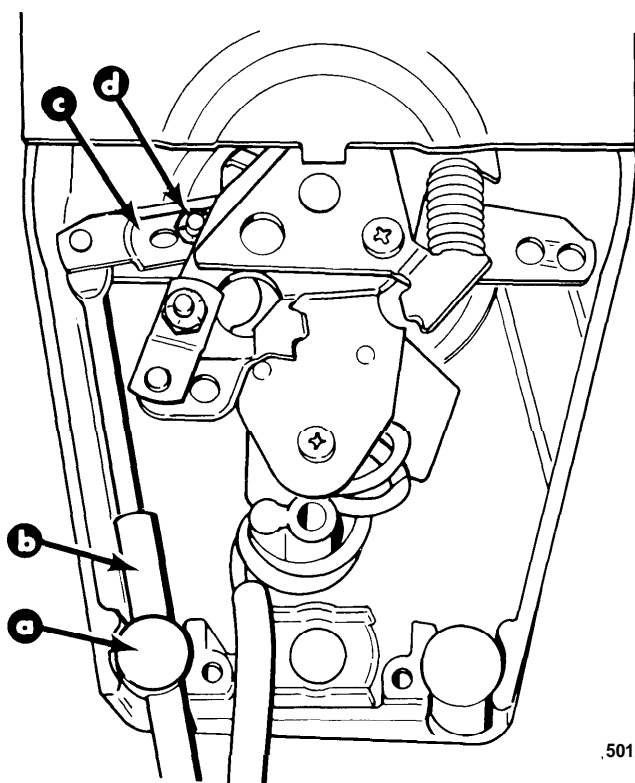

- a - Shift Anchor Barrel
- b - Shift Cable
- c - Cable Fastener
- d - Cable Fastener Locknut

IMPORTANT: Cable fastener (c) must be relocated to position as shown.

Torque shift cable fastener locknut to 20 to 25 lbs. in. (2.3 to 2.8 N.m.)

Throttle Cable

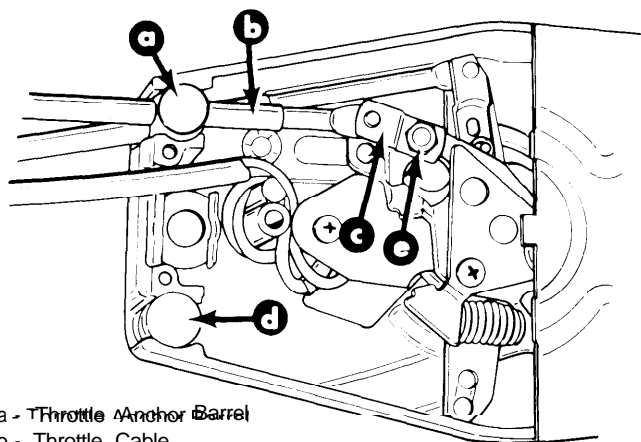

- a - Throttle Anchor Barrel
- b - Throttle Cable
- c - Cable Fastener
- d - Spacers (From Parts Bag)
- e - Cable Fastener Locknut

50092

Torque throttle cable fastener locknut to 20 to 25 lbs. in. (2.3 to 2.8 N.m.)

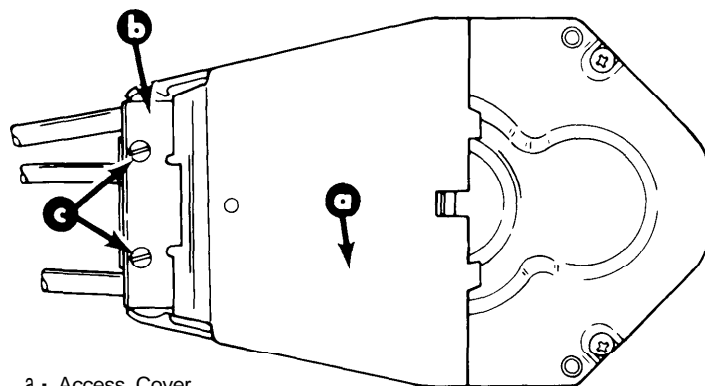

- a - Access Cover
- b - Cable Retainer
- c - Screws

50030

Position access cover and cable retainer onto back side of control and secure both to control with 2 screws. Torque access cover and cable retainer screws to 60 lbs. in. (7 N.m.)

Remote Control Mounting

CAUTION

This trim control can be connected only to Power Trims that are equipped with a 2-solenoid trim pump. If Power Trim is equipped with only one solenoid, a Trim Solenoid Kit must be purchased and installed on Power Trim pump.

Locating and Drilling Mounting Area for Remote Control

CAUTION

Area directly under control must be free of obstructions (bulkhead, braces, etc.) Cables always must protrude from rear of control, extending straight-down and parallel to each other. Radius (at point where cables are routed toward stern of boat) must not be less than 12" (30.5cm). This will prevent placing a load or bind on control cables that would result in hard shifting or binding throttle action.

1. Locate area where control will be mounted in boat. Be sure to allow sufficient clearance for control handles when they are in full forward and full reverse position.
2. Place Template (provided on last page) over area where control is to be mounted.
3. Cut and drill mounting area as indicated on template.

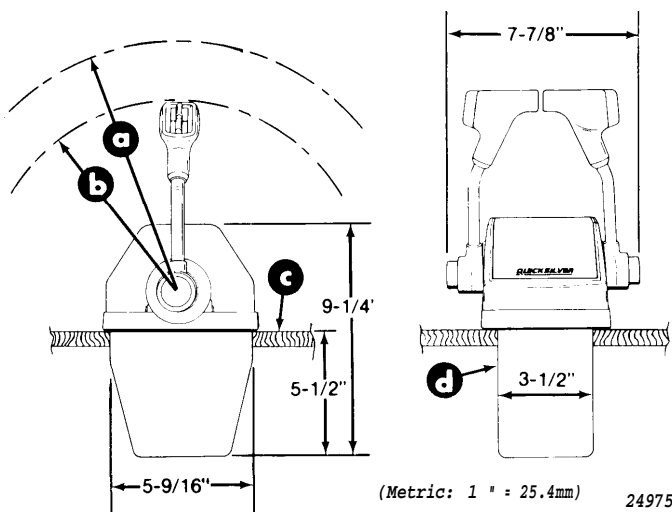

- a - 9-3/8 in. (24.45cm) Radius Provides 2 in. (51mm) Hand Clearance
 b - 7-3/8 in. (19.37cm) Radius Maximum Travel Available
 c - Mounting Surface
 d - Dual Console Control

Clearance Requirements

Mounting Control

1. Place control modules back-to-back, then position a mounting bracket onto each module and secure brackets and modules together with two 4 in. (10.2cm) screws and locknuts. Do not tighten locknuts securely at this time).

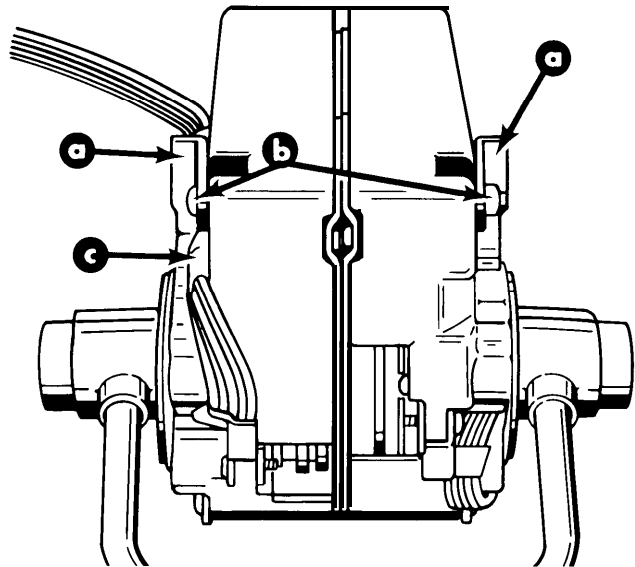

50092

- a - Mounting Brackets
 b - Screws and Locknuts
 c - Plastic Sleeve

Mounting Brackets Installed on Control Modules

2. Insert wellnut fasteners into drilled holes with flange against the outer surface.

NOTE: It may be helpful to thread a mounting screw into wellnut when inserting into drilled hole.

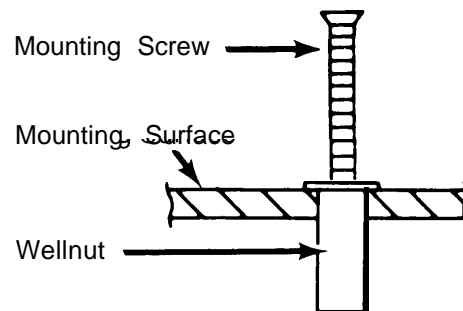

3. Feed control cables, neutral start safety switch wiring harnesses and trim harness thru control base and opening in mounting panel (cut previously) and set control in position.

⚠ WARNING

Trim wiring harness must be positioned with plastic sleeves (on harness) at the exact location shown to keep harnesses from being pinched or cut by mounting brackets.

4. Position trim harness so that plastic sleeve is at the exact location shown.
5. Insert mounting screws (4) thru control mounting brackets, control base and mounting panel. Tighten securely.
6. Move one control handle to full "Forward" position and one control handle to full "Reverse" position. Apply a slight amount of downward force on each handle to align the 2 control modules, then torque locknuts (which secure mounting brackets on control modules together) to 35 lbs. in. (4 N.m.)

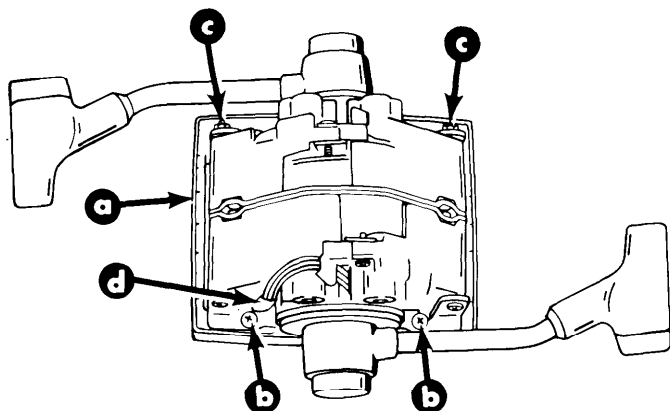

50058

- a - Control Base
- b - Control Mounting Screws
- c - Locknuts (Torque to 35 lb. in.)
- d - Plastic Sleeve

⚠ WARNING

Set screws in control handles must be torqued to specification. Failure to tighten set screws securely could allow control handles to disengage, with subsequent loss of throttle and shift control.

7. Move control handles to allow access to set screws. Torque set screws to 60 lbs. in. (7 N.m.)

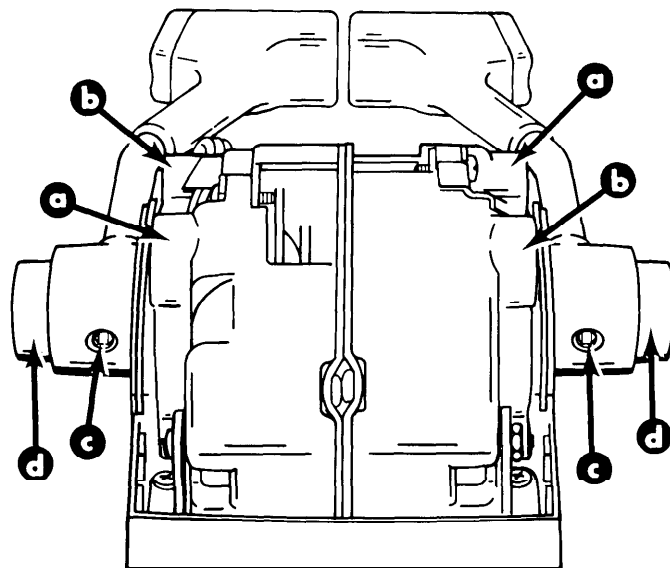

50058

- a - Detent Adjustment Screw
- b - Control Handle Friction Screw
- c - Set Screw
- d - "Throttle-Only" Button

8. Install cover by snapping into control base.

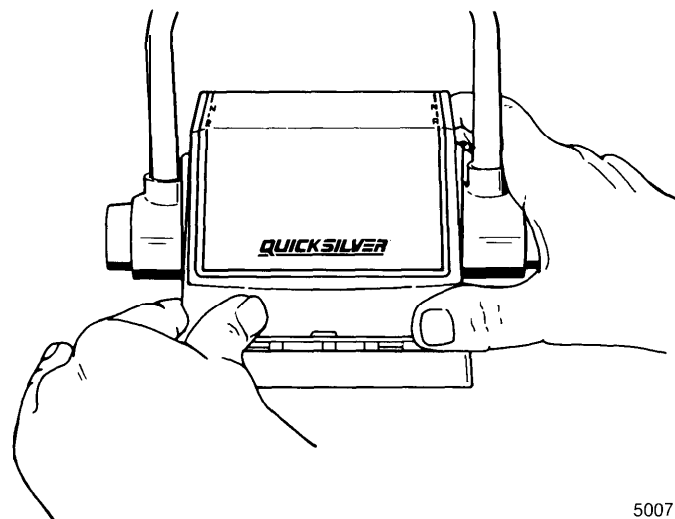

50071

Trailer Switch Installation

IMPORTANT: Route switch to desired location to ensure adequate wire length and clearance behind mounting area.

1. Cut a **2-1/8 in. (54mm)** diameter hole at desired location.
2. Thread studs into bezel, tighten securely, but do not overtighten.
3. Place switch thru mounting clamp opening and thru mounting area (from back).
4. Install switch (lever pointing downward) thru mounting bezel and faceplate and secure with special nut. Tighten securely.
5. Insert mounting bezel into mounting opening and install mounting clamp, secure with washer and nuts. Tighten securely but do not overtighten.

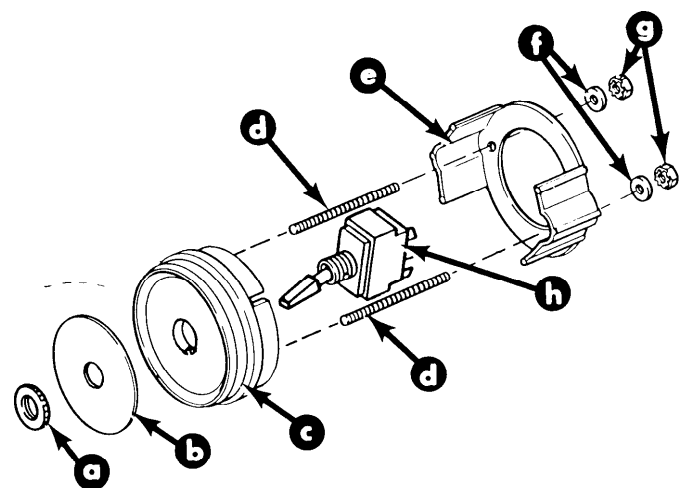

- a - Special Nut
- b - Face Plate
- c - Mounting Bezel
- d - Studs
- e - Mounting Clamp
- f - Washers
- g - Nuts
- h - Trailer Switch

Neutral Safety Switch and Power Trim Connections

⚠WARNING

Failure to connect neutral start safety switch leads properly could allow engine to start while in gear. If engine starts while in gear, immediate boat movement and a hazard to unseated occupants of boat or persons and property outside of boat may result.

⚠CAUTION

Neutral start safety switches must be connected with port control module switch to port engine and starboard control module switch to starboard engine for correct safety starting feature to function.

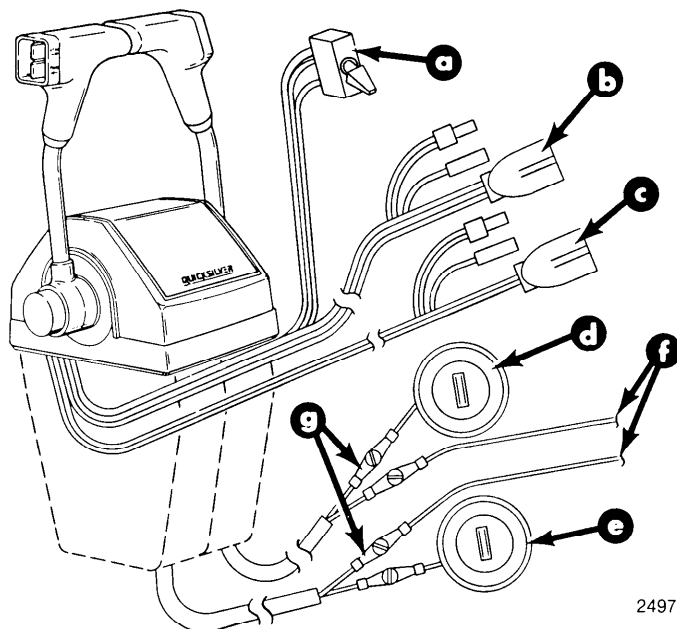

24976

- a - Trailer Switch
- b - To Starboard Trim Pump
- c - To Port Trim Pump
- d - Starboard Key Switch
- e - Port Key Switch
- f - To Engine Wiring Harnesses
- g - Neutral Start Safety Switch Connections

Connect Wires Together with Screws and Hex Nuts Apply Liquid Neoprene to Connections and Slide Rubber Sleeve OVER Each Connection

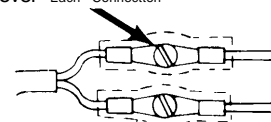

IMPORTANT: When routing neutral start safety switch harness, secure each harness every 18" (45.7cm). Be sure that wiring does not rub or get pinched and that it does not come in contact with water.

Plug trim connections from control into connectors from power trim units.

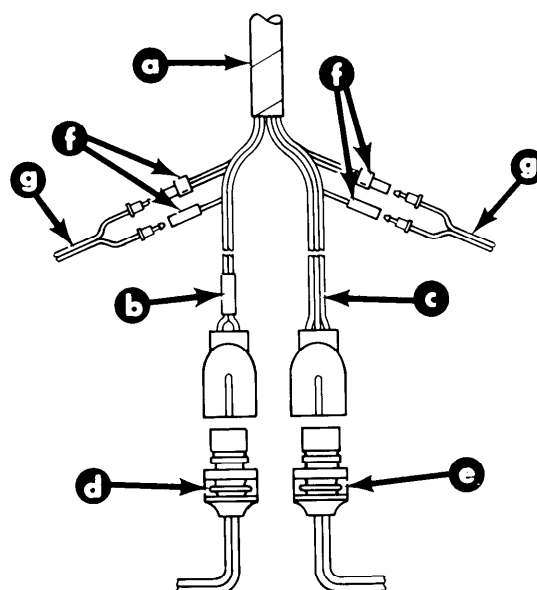

50126

- a - Trim Harness (From Remote Controls)
- b - 2 Wire Connector (Port)
- c - 3 Wire Connector (Starboard)
- d - Port - Power Trim Pump
- e - Starboard - Power Trim Pump
- f - To Trim Limit Switch
- g - Trim Limit Switch

Repositioning Control Handles

NOTE: Repositioning of control handle (on control shafts) is necessary only if the standard neutral position of control handles are undesirable.

IMPORTANT: When repositioning control handles (on control shafts), position handles so that full forward and reverse can be achieved.

⚠ WARNING

Before repositioning control handles on control shafts, be sure to disconnect the trim wire connectors.

1. Disconnect the trim connections from power trim pumps and trim limit switches.

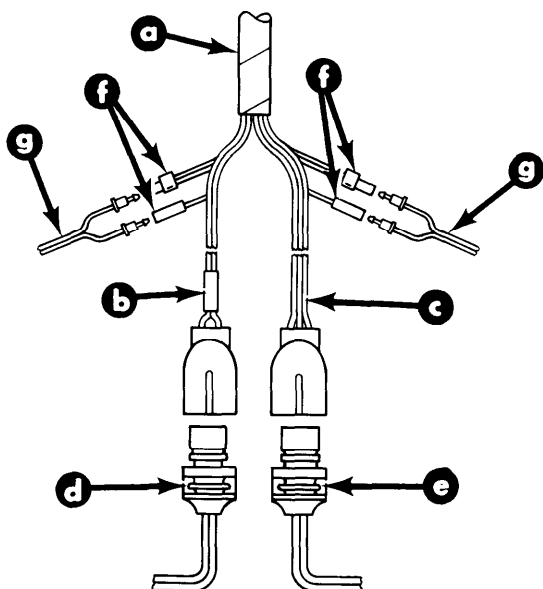

- a - Trim Harness (From Remote Controls)
- b - 2 Wire Connector (Port)
- c - 3 Wire Connector (Starboard)
- d - Port - Power Trim Pump
- e - Starboard - Power Trim Pump
- f - To Trim Limit Switch
- g - Trim Limit Switch

50126

2. Pry trim switch retainer from shift/throttle handle.

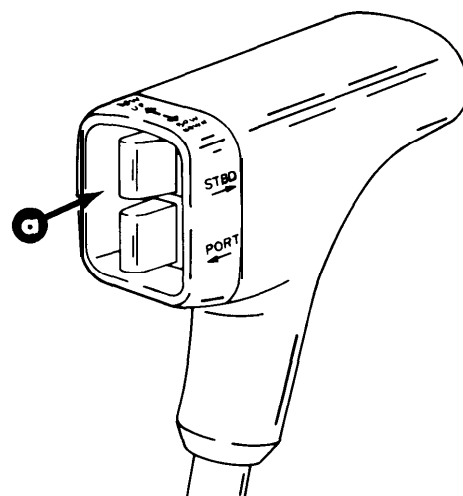

50063

a - Retainer/Cover

3. Pull trim switches out from handle and remove wires from switches.

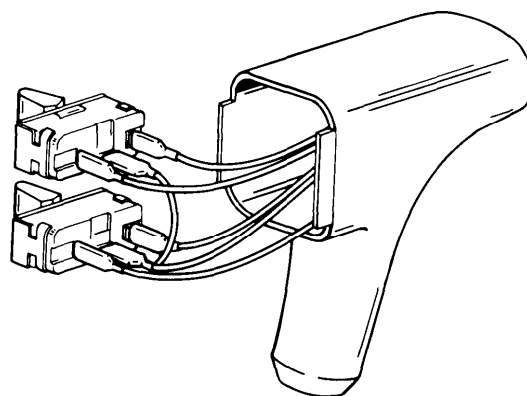

50091

4. Pull throttle only buttons from control shaft.

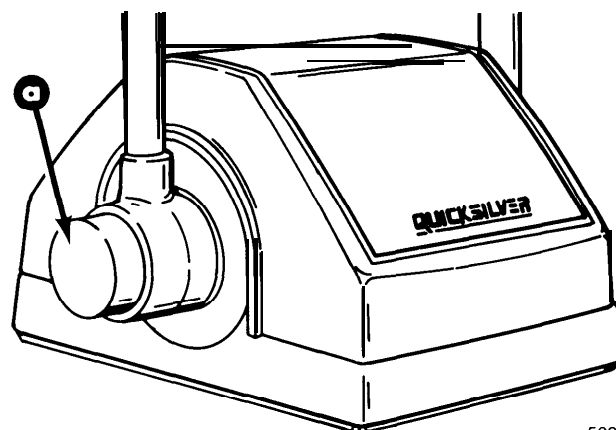

50030

a - Throttle Only Button

5. Position handles to allow access to set screw and loosen screws.
6. Return handles to neutral position and remove handles from shafts (only far enough to rotate handle.)

7. Rotate trim wires and trim wire rotator (on control shaft) to the position that neutral is desired when control handle is reinstalled.

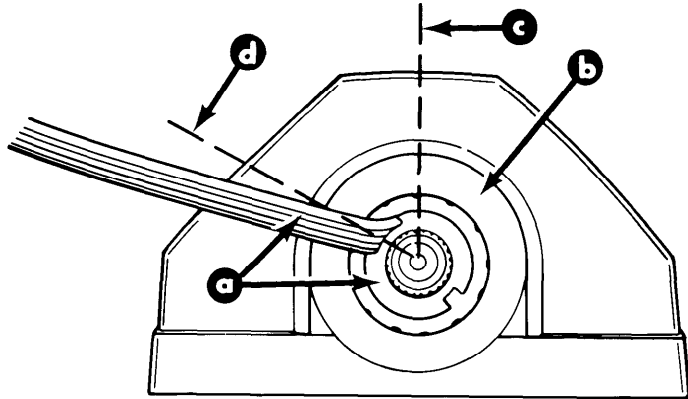

50092

- a - Trim Wires and Rotator
- b - Spacer Disc
- c - Standard Position of Trim Wires and Rotator
- d - If Trim Wires and Rotator are Moved to This Angle (or Any Other Angle) from the Standard Position, the Control Handle Must Also Be Installed (on Control Shaft) in the Same Angle (thus Neutral is Changed to This Angle from Standard Neutral Position)

8. Reinstall handle to control shaft (make certain full forward and full reverse can be achieved) at desired location.

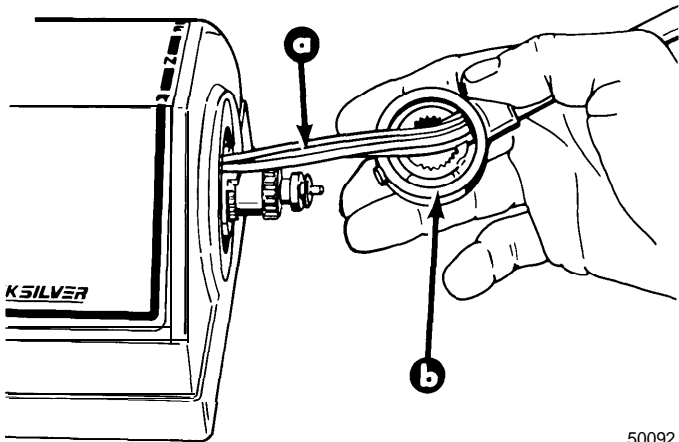

50092

- a - Trim Wires
- b - Control Handle

⚠ WARNING

Control handle set screw must be torqued to specification. Failure to tighten set screws securely could allow control handle to disengage, with subsequent loss of throttle/shift control.

9. While holding is on hub of control handle, move handle until access to set screw is achieved. Torque control handle set screw to 60 lbs. in. (7 N.m.)
10. Push the "Throttle-Only" button onto control shaft.

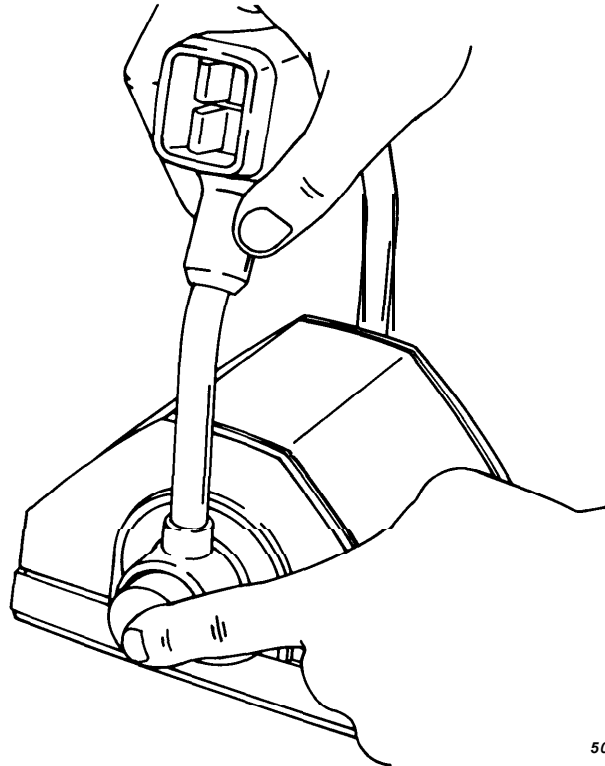

50063

11. Reconnect trim wires to terminals on trim switch.

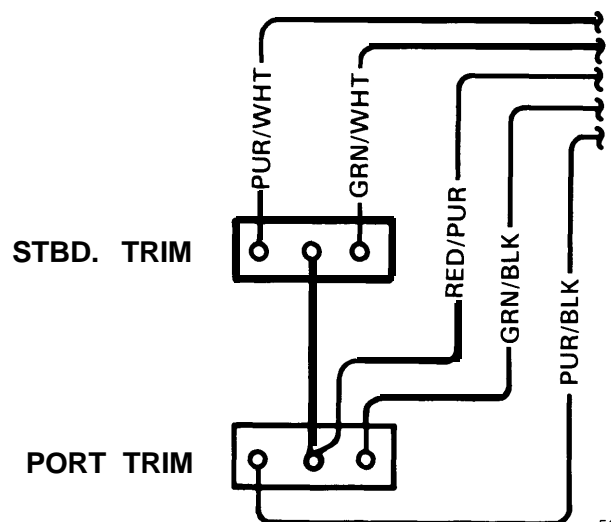

50091

12. Place trim switches into handle, and install trim switch retainer/cover onto handle.
13. Reconnect trim wire connections to ignition switch connections.

Operation

1. **The Control handles** feature full gear shift and throttle. Always shift with a firm, quick motion. Approximately the first 40-degrees of control handle travel ("Forward" and "Reverse") shifts the engines. Remainder of control handle movement advances the throttle. **DO NOT** try to shift into "Reverse", if control is used with an outboard and outboard is not running. Forcing shift lever (on an outboard) under this condition may result in damaged shift mechanism.
2. **"Throttle-Only" button** (located in the center of each control handle hub) allows engine throttle advancement without shifting the engines. This is done by disengaging the shift mechanism from the control handle. "Throttle-Only" buttons can be depressed only when control handles are in neutral, and should be used only to assist in starting the engines.
3. **Detent adjustment screw** is located in each control module. The detent adjustment screws will increase or decrease the effort necessary to move control handles in or out of neutral position. To increase detent, thread detent screws "in" (clockwise.) To decrease detent, thread detent screws "out" (counterclockwise.) (**DO NOT** thread detent screws all-the-way out.)
4. **Control handle friction screw** is located in each control module. The control handle friction screws are an adjustment that sustains a set engine speed without the driver's hand holding onto the control handles. To increase control handle friction, thread friction screws "in" (clockwise). To decrease control handle friction, thread friction screws "out" (counterclockwise.) (**DO NOT** thread friction screws all-the-way out.)
5. **Trim Switch:** Push toward "UP" to trim power package out or push toward "DOWN" to trim in.
6. **Trailer Switch:** Used to raise power package to desired height for trailering, launching, beaching or shallow water operation.

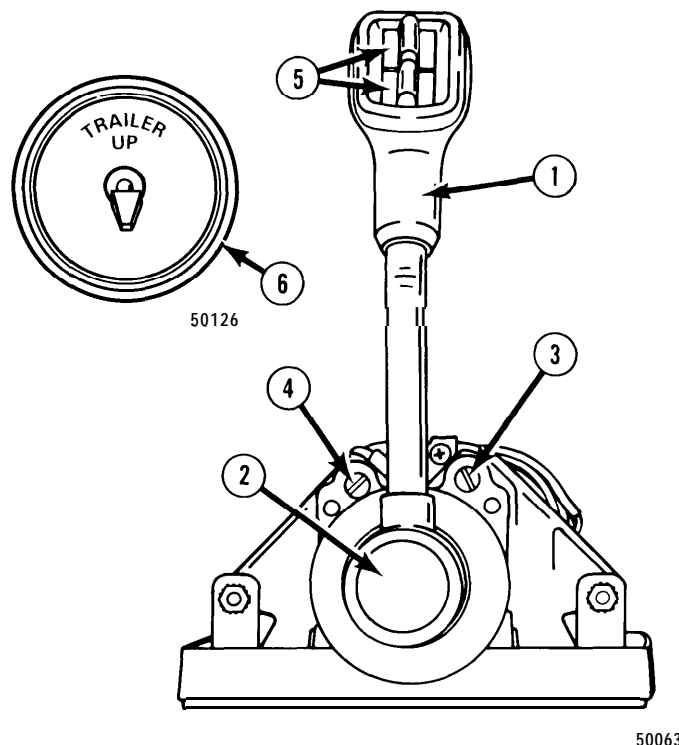

⚠ CAUTION

If engine will be operated in shallow water with lower unit trimmed follow these precautions:

1. **Do not operate engine above idle RPM. (When lower unit is trimmed beyond side supports the lower unit will have no side support).**
2. **Check that water level is above water intake ports. (should water level fall below water intake ports, damage from overheating or water pump impeller damage could occur.)**

NOTE: If the trim switch remains pushed toward the "DOWN" position, after unit reaches its end of travel, an overload cut-out switch will open and pump motor will stop. To prevent cut-out switch from opening, it is recommended that trim switch be released as soon as unit reaches end of travel. If cut-out switch should open, do not depress switch or button for approximately one minute. After this period of time, cut-out switch will close (reset itself) and pump again may be operated.

Template for Dual and Single Console Controls

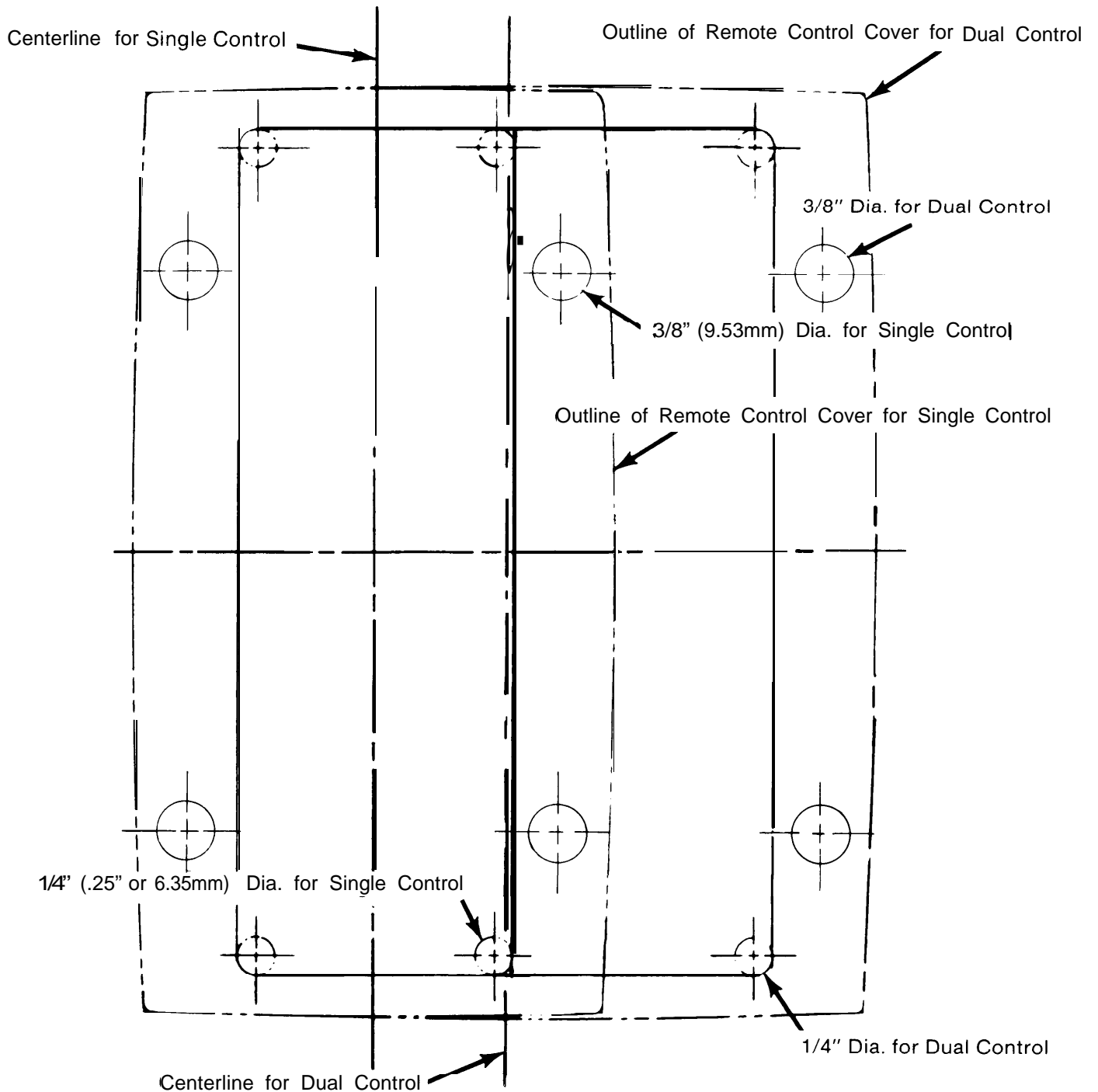

▲CAUTION

Area (located directly under mounting panel) must be free from obstructions and must allow cables to form a gradual bend when routed toward stern of boat.